



TIGER | STORBOX 400
FOLDING-ARM AWNING SYSTEM



The Dog Over Peckover, Knutsford



The Dakota Hotel, Manchester



Residential Client, Sandbanks

TIGER | STORBOX 400 FOLDING-ARM AWNING SYSTEM

Tiger | Storbox 400 – The awning with clean lines and elegant design.

The UK public are becoming more accustomed to enjoying drinking and dining outdoors. Patios and decking areas at both residential locations and also commercial sites such as pubs, bars and restaurants are increasingly popular spaces to enjoy a meal, drinks and social gatherings.

Designed to improve the appearance of outdoor residential and commercial spaces, a Tiger | Storbox 400 protects users from both the sun, but also just as importantly any adverse weather conditions providing a reliable, durable and dynamic shelter. Since 1993, the Tiger | Storbox 400 folding-arm awning has been constantly evolving to set new trends.

The maximum dimensions are 6,000mm width x 4,000mm projection, providing a maximum of 24m² of shade and coverage, the Tiger | Storbox 400 patio awning is our premium folding-arm awning system. With its modern and quadrilateral, flush and full cassette design, it integrates seamlessly within a variety of different architectural styles to the building's façade, giving a contemporary and solid appearance, when retracted.

Dimmable LED lighting can also be integrated into the front profile fascia, as well as within the heavy duty ONYX-LUX arms, guaranteeing at least 10,000 arm movements and ensuring peak fabric tension at every position, suitable for even the most challenging of applications.

Tiger | Storbox 400 revolutionises, with its aesthetic full of strength and vitality.

- Lateral end caps are manufactured in a lacquered aluminium.
- Elegant, uniform colours and textures.
- Easily integrated with a variety of different architectural styles.
- Design based on the aerodynamics of the Formula 1 concept.
- Larger protection capacity: 6,000mm width x 4,000mm projection.
- LED lighting can be integrated within the front profile, as well as integration within the ONYX-LUX arms for 24 hour usage.
- The pitch adjustment system, used while the awning is closed, is quick and precise, guaranteeing an impeccable result.
- Available in a wide range of colours.

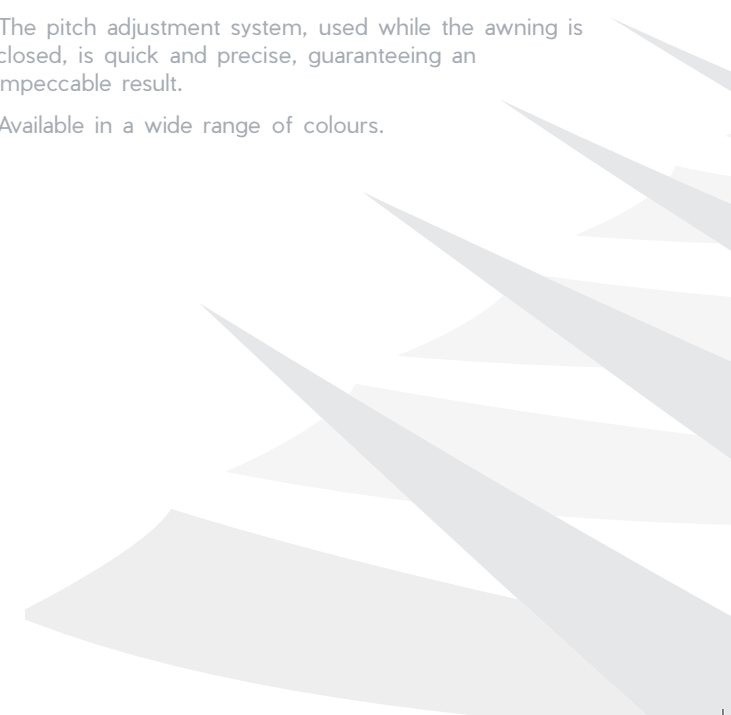

TIGER | STORBOX 400 FOLDING-ARM AWNING SYSTEM

Technical Information.

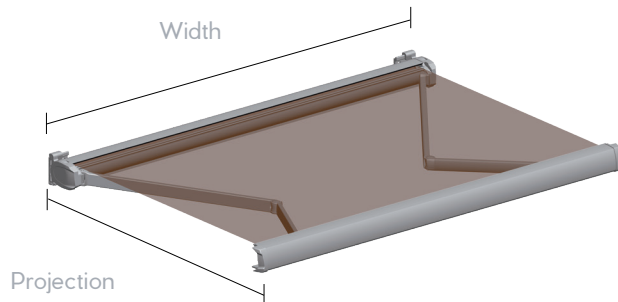

Note, it is always advisable to specify a motor for projections over 3000mm.

Specification:

- > Arms: 2
- > Width: 6,000mm
- > Height: 4,000mm

Operation:

- > Manual
- > Motorised
- > Automated

Application:

- > Balconies
- > Terraces
- > Catering

Finishes:

- > Lacquer in accordance with QUALICOAT standards
- > Stainless steel screws and bolts
- > Arms with integral lacquering

Installation:

- > Wall
- > Ceiling

Classification:

- > Wind: Up to 28 km/h
- > Standards: UNE-EN 13561:2015

Lighting Options:

- > Cassette profile
- > Front profile
- > Arms (Onyx Lux)

Pitch:

- > Wall Installation



Dimensions:

Motor and Interior Gearbox

- > Wall Installation

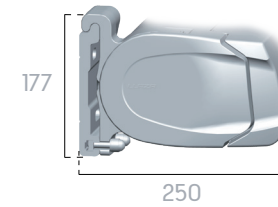

- > Ceiling Installation

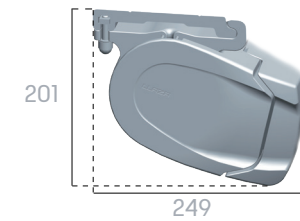

Exterior Gearbox and Motor

- > Wall Installation

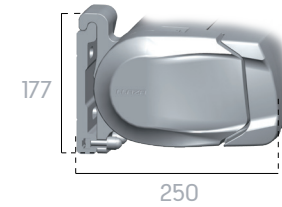

- > Ceiling Installation

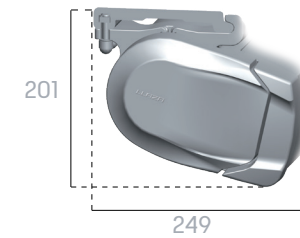

- > Ceiling Installation



6° with complementary support





ROLLER BLINDS



VERTICAL BLINDS



SKYLIGHT BLINDS



BESPOKE BLINDS



AWNINGS



CANOPIES



PARASOLS



GLASS PERGOLAS



RETRACTABLE ROOFS



BARRIERS



PLANTERS



RETRACTABLE
PARAPET GLASS



JAMES ROBERTSHAW

est.1860

BESPOKE AWNINGS & BLINDS

t: 01204 574 764 | e: sales@jamesrobertshaw.co.uk | www.jamesrobertshaw.co.uk